

Portable DC Voltage Regulator Power Supply Module

(DC 6-30V to 0-36V 5A)

Model: U6230

INTRODUCTION

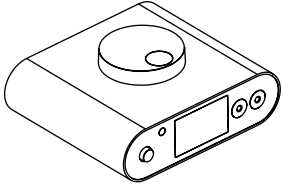

UCTRONICS U6230 is a 180W DC buck-boost converter and stabilized power supply module that outputs constant voltage (DC 0V-36V) with an input voltage DC 6.0V-30V.

Encoder Knob:

1. Rotate the knob to switch the parameter pages in default mode;
2. Short press the knob to select the parameter in the current page, then rotate the knob to switch the parameter, short press the knob to select the parameter need to be adjusted, the background of the

3. Rotate clockwise to increase and counterclockwise to decrease the value, or toggle the state of the parameter. Rapid rotation supported;
4. Long press the knob for 2 seconds or no operation for 6 seconds, the module will exit the parameter setting mode, The parameters will be saved automatically.

ON/OFF Button:

1. Short press the ON/OFF button to turn on/off the output power;
2. Long press the button to shut off, the indicator keeps on by default.

INTERFACES

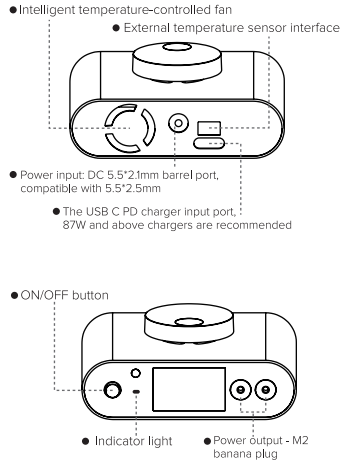

SPECIFICATIONS

- Input Voltage: DC 6.0V-30.0V
- Input Voltage: Max. 10.0A
- Output Voltage: DC 0.0V-36.0V
- Output Current: 0.0-5.1A
- Output Power: 180W
- Current Accuracy: $\pm(0.5\%+3 \text{ digits})$, increment 0.001A
- Voltage Accuracy: $\pm(0.4\%+1 \text{ digits})$, increment 0.01V
- Safety Protection: anti-reverse protection, overvoltage protection (OVP), overcurrent protection (OCP), over-power protection (OPP), low-voltage protection (LVP), over-temperature protection (OTP)
- Overall Dimension: 77mm*66mm*29mm
- Weight: 245g

NOTE:

- Please ensure the input voltage higher than 20V and power higher than 200W if full load output is needed.
- A diode in series with the output-anode must be required to anti-backflow at output terminal when charging a battery or connecting a capacitive load, otherwise the regulator will be damaged.

PARAMETER SETTINGS

Rotate the knob to switch the parameter pages, short press the knob to select the parameter in the current page, then rotate the knob to switch the parameter, short press the knob to select the parameter need to be adjusted, the background of the selected parameter will be blue. Rotate the knob to change the parameter. Long press

the knob for 2 seconds to exit the setting mode. The parameters will be saved automatically.

Parameter Pages

1. The power main interface:

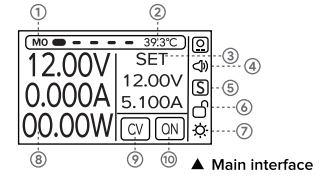

- ① Data array
- ② Product temperature/external probe temperature
- ③ Output voltage and Max. current setting value
- ④ Buzzer indication
- ⑤ Shift button indication
- ⑥ Lock/unlock indication
- ⑦ Brightness/Screen off duration
- ⑧ Output voltage current and power
- ⑨ CC/CV or alarm code display
- ⑩ Output on/off

2. Capacity record:

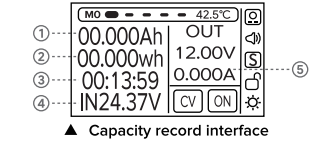

- ① Electric capacity
- ② Electric quantity
- ③ Running time
- ④ Input voltage
- ⑤ Output voltage and current

If any problem, feel free to contact us.
 Website: www.uctronics.com
 Email: support@uctronics.com

CONTACT US

Item	Value	Explanation
Maximum electric quantity (QWH)	000.00Wh	If setting the value, the output and flash "QWH" when the electric quantity of discharge reaches the value.
Maximum discharging time (QHP)	000:00h	If setting the value, the module will shut down the output and flash "QHP" when the duration of discharge reaches the value.

Item	Value	Explanation
Data array (PRE)	M0	The power output is turned off by default. The power output will be displayed at the top. group serial number arrays, the current data group will call M/M2 data on any page for 2 seconds. Press the knob for 2 seconds to exit the setting mode.
Voltage range (VSET)	12V	Adjustable range: 0-36V
Current range (ISET)	5.1A	Adjustable range: 0-5.1A
Overvoltage protection (OVP)	37V	Can be set, when the power reaches the value, the module displays alarm code and shuts down.
Overcurrent protection (OCP)	5.6A	When the voltage falls down to the value, the module displays alarm code and shuts down.
Over-power protection (OPP)	205W	When the voltage falls down to the value, the module displays alarm code and shuts down.
Low-voltage protection (LVP)	4.0V	When the voltage falls down to the value, the module displays alarm code and shuts down.
Maximum electric capacity (QAH)	00.00Ah	If setting the value, the output and flash "QAH" when the electric capacity of discharge reaches the value.

Default value and explanation of each parameter item as is shown below:

