

ASSEMBLY

www.uctronics.com **RACK MOUNT SERIES**

GUIDE

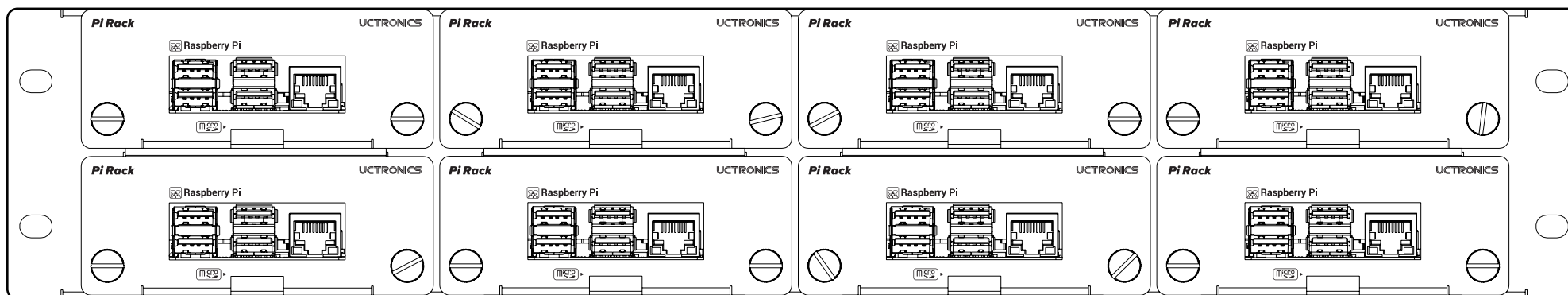

CONTACT US

If any problem, feel free to contact us.
 Website: www.uctronics.com
 Email: support@uctronics.com



SKU:RM0009



Package Contents

01

Rackmount × 1

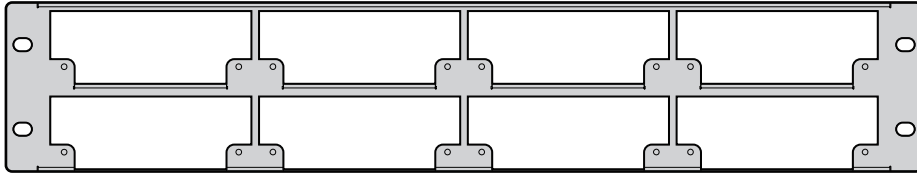

02

Raspberry Pi Bracket × 8

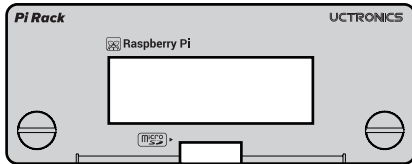

03

Bracket cover × 2



04

M3 hand screw × 4

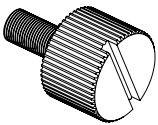

05

M2.5*5 screws × 32

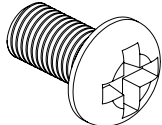

06

M6 Rack screws × 4

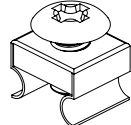

Installation

1

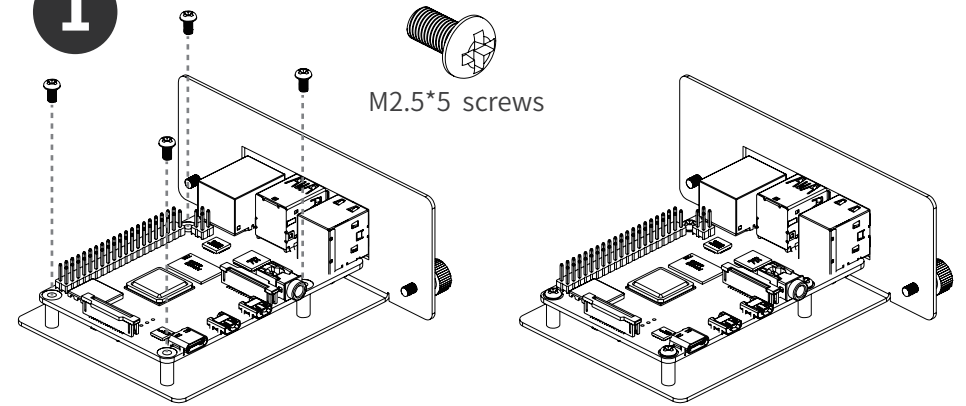

1. Secure the Raspberry Pi with M2.5*5 round head screws.

2. Simply introduce the installed bracket into the rackmount and secure the captive loose-off screws.

